



# NORANDEX<sup>®</sup>

## WRAP

**NORANDEX HOUSEWRAP** will assure you are protecting your customer's home with a superior weather resistant barrier. Just one small way Norandex is putting your needs first.

Norandex Housewrap can be imprinted with business logo for maximum advertising exposure!!



### **Housewrap is the “best practice” for protecting a home from wind and water while allowing it to breathe. Norandex makes it easy!**

- Stronger than ever, our wrap can be installed with staples. No need for expensive cap nails
- Perm rating is appropriate for all climates
- Not affected by surfactants, such as soaps, cleaning agents, detergents
- Can be used under all types of products (e.g. vinyl siding, stucco, wood, steel, brick, stone and fiber cement)
- Features 9-month protection from ultraviolet degradation
- Lightweight and easy to cut
- Translucent so you can see through the wrap where to staple or nail
- Standard Norandex product is shipped within 5 days or less (NOT applicable to custom imprint orders)
- Micro-perforated to allow waterborne vapor to permeate out through the wrap and into the atmosphere
- Improves efficiency of wall insulation and seals cracks and seams in walls to reduce drafts for a more comfortable home
- Woven, polypropylene wrap is both tough and tear resistant
- Will not support mold growth
- Meets or exceeds standards for all code approvals
- Easy to order
- Custom imprinting program available with customer logo (one pallet minimum)
- Custom imprint orders will arrive within 14 days of receipt of order

## NORANDEX HOUSEWRAP SPECIFICATIONS

	Product Specification	Test Method
Composition	Woven Polypropylene	
Weight Per Roll	11.8 lbs./MSF	
Thickness	5.5 mils	
Tensile Strength		ASTM D-882
Machine Direction	45.17	
Cross Direction	50.77	
Tear Strength		ASTM D-5034
Machine Direction	34.13	
Cross Direction	36.53	
Water Resistance	Pass	ASTM D-1709
MVTR/Perms	8 Perms	ASTM E-96
Fire Rating	Class A	ASTM E-94

Roll Size	Rolls per Pallet
9 ft x 100 ft	50
9 ft x 150 ft	45
9 ft x 195 ft	40
10 ft x 100 ft	50
10 ft x 150 ft	45
10 ft x 195 ft	40
4.5 ft x 100 ft	100



### SEAMING TAPE

Order in case qty (16 tape rolls/case)  
size: 3" x 165 feet

Freight prepaid on tape when ordered with a pallet of housewrap

Norandex Housewrap meets all national code requirements and can be used under all types of siding and masonry cladding materials. (Vinyl siding, stucco, wood, steel, brick, stone and fiber cement).

Meets the latest ICC Code requirements for water resistive barrier as well as new air barrier requirement with an air leakage rate of less than 0.02 L/S/m<sup>2</sup> per ASTM 2178-03 in accordance with ICC AS-38.

## Custom Imprinting Available!

Put your name right in the center of every wall you cover with our custom-imprinting program. Order your personalized house wrap one pallet at a time with no plate charges or additional printing fees. Order will arrive within 14 days of factory receipt of order.

Minimum Quantity:	One Pallet
Additional Charge:	None
Plate Charge:	None (Up to 500 square inches max)
1 or 2 colors Logo:	Standard colors at no additional charge

(Customization N/A on 3' x 150')

<b>RED</b> PMS 186	<b>PURPLE</b> PMS 274	<b>GREEN</b> PMS 382
<b>RED</b> PMS 202	<b>BLUE</b> PMS 280	<b>BROWN</b> PMS 4635
<b>BURGUNDY</b> PMS 492	<b>BLUE</b> PMS 287	<b>BROWN</b> PMS 464
<b>ORANGE</b> PMS 485	<b>BLUE</b> PMS 293	<b>BLACK</b>
<b>ORANGE PMS</b> 172	<b>GREEN</b> PMS 357	<b>GRAY</b> PMS 425
<b>ORANGE</b> PMS 151	<b>GREEN</b> PMS 342	<b>GRAY</b> PMS 430
<b>YELLOW</b> PANTONE C	<b>GREEN</b> PMS 361	<b>Standard Colors Available</b>
<b>YELLOW</b> PMS 141	<b>GREEN</b> PMS 376	



## NORANDEX PLUS HOUSEWRAP SPECIFICATIONS

Norandex Plus housewrap meets all national code requirements and can be used under all types of siding and masonry cladding materials such as vinyl siding, wood, steel, brick, stone and fiber cement.

- Tiny micro perforations allow moisture vapor inside the wall cavity to escape, and prevents moisture condensation
- Light weight and easy to install
- Tear resistance reduces jobsite waste
- Meets or exceeds all building codes
- Nationwide Distribution

Product Specification		Test
Composition	Woven Polypropylene	
Weight Per Roll	14.4 lbs/MSF	
Thickness	6.5 mils	
Tensile Strength		ASTM D-882
Machine Direction	58	
Cross Direction	44	
Tear Strength		ASTM D-5034
Machine Direction	42	
Cross Direction	38	
Water Resistance	Pass	ASTM D-1709
MVTR/Perms	9 Perms	ASTM E-96
Fire Rating	Class A	ASTM E-94

Roll Size	Rolls per Pallet
9 ft x 100 ft	50
9 ft x 150 ft	45
9 ft x 195 ft	40
10 ft x 100 ft	50
10 ft x 150 ft	45
10 ft x 195 ft	40
3 ft x 150 ft	135

**Norandex Plus Housewrap  
can be imprinted with YOUR LOGO!!**

Put your name right in the center of every wall you cover with our FREE custom-imprinting program. Order your personalized house wrap one pallet at a time with no plate charges or additional printing fees. Order will arrive within 14 days of factory receipt of order. *(Customization N/A on 3' x 150')*

Minimum Quantity: One Pallet  
 Additional Charge: None  
 Plate Charge: None (Up to 500 square inches maximum)  
 Select 1 or 2 colors for Logo: Standard colors offered at no additional charge

**Standard Imprint Colors**

RED PMS 186	GREEN PMS 376	GREEN PMS 382
RED PMS 202	BROWN PMS 464	PURPLE PMS 274
BLUE PMS 280	GRAY PMS 430	BURGUNDY PMS 492
BLUE PMS 287	GREEN PMS 361	BLACK
BLUE PMS 293	ORANGE PMS 151	YELLOW PANTONE C
GREEN PMS 357	ORANGE PMS 172	YELLOW PMS 141
GREEN PMS 342	ORANGE PMS 485	BROWN PMS 4635
		GRAY PMS 425

**SEAMING TAPE:** Order in case qty (16 tape rolls/case) size: 3" x 165 feet  
 Freight prepaid on seaming tape when ordered with a pallet of housewrap

# X WRAP

## Low Perm

### PRODUCT SPECIFICATIONS

**X Wrap Low Perm** is the only choice for demanding applications to protect from severe weather conditions and environments. **X Wrap Low Perm** prevents the infiltration of air and water while still allowing for the escape of water vapor. The most unique feature is the *ALTA 360 degree* drainage that no other wrap in the world can give. The *ALTA 360 degree* drains in EVERY direction, no matter the final wall cladding, wood, vinyl, metal, brick, stone, cement sidings, stucco or EFIS. The incorporation of *ALTA 360 degree* makes **X Wrap Low Perm** a one of a kind all weather protection layer for any type of construction with the assurance of quality and lifelong service.

- Custom print available in two colors, with one pallet minimum, at no additional cost
- Nationwide distribution

Roll Size	Rolls Per Pallet
36" x 100'	50 Rolls
36" x 150'	45 Rolls
54" x 100'	100 Rolls
54" x 150'	90 Rolls
9' x 100'	50 Rolls
9' x 150'	45 Rolls
9' x 195'	40 Rolls
10' x 100'	50 Rolls
10' x 150'	45 Rolls
10' x 195'	40 Rolls

Product Specifications		Test Method
Air Penetration Resistance	0.0013	ASTM E2178 (cfm/ft <sup>2</sup> @1.57 psf)
	>2000	Gurley Hill (TAPPI-T460) (sec/100cm)
Water Vapor Transmission	105	ASTM E96 Method A (g/m <sup>2</sup> /24 hrs)
	15	(perms)
	72	ASTM E96 Method B (g/m <sup>2</sup> /24 hrs)
	10.4	(perms)
Water Penetration Resistance	>300	AATCC 127 (cm)
Basis Weight	2.2	TAPPI T-410 (oz/sq yd)
Thickness	8	ASTM D3776 (mils)
Breaking Strength	30	ASTM D882 (lb/in) MD
	30	ASTM D882 (lb/in) CD
Dry Tensile	45	ASTM D5034 (lb/in) MD
	45	ASTM D5034 (lb/in) CD
Tear Resistance (Trapezoid)	13.5	ASTM D1117 (lbs) MD
	12.5	ASTM D1117 (lbs) CD
Drainage Efficiency	>95%	ASTM E2273
	>95%	ICC-ES AC 235 Section 4.5
Surface Burning Characteristics	5 Class A	ASTM E84 Flame Spread Index
	45 Class A	Smoke Develop Index
Ultra Violet Light Exposure	180 days	

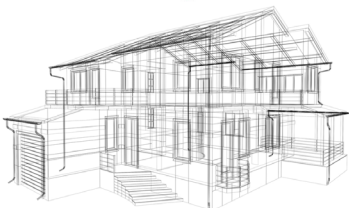

# X WRAP

## High Perm

### PRODUCT SPECIFICATIONS

**X Wrap High Perm** is the only choice for demanding applications to protect from severe weather conditions and environments. **X Wrap High Perm** prevents the infiltration of air and water while still allowing for the escape of water vapor. The most unique feature is the *ALTA 360 degree* drainage that no other wrap in the world can give. The *ALTA 360 degree* drains in EVERY direction, no matter the final wall cladding, wood, vinyl, metal, brick, stone, cement sidings, stucco or EFIS. The incorporation of *ALTA 360 degree* makes **X Wrap High Perm** a one of a kind all weather protection layer for any type of construction with the assurance of quality and lifelong service.

- Custom print available in two colors, with one pallet minimum, at no additional cost
- Nationwide distribution

Roll Size	Rolls Per Pallet
36" x 100'	50 Rolls
36" x 150'	45 Rolls
54" x 100'	100 Rolls
54" x 150'	90 Rolls
9' x 100'	50 Rolls
9' x 150'	45 Rolls
9' x 195'	40 Rolls
10' x 100'	50 Rolls
10' x 150'	45 Rolls
10' x 195'	40 Rolls

Product Specifications		Test Method
Air Penetration Resistance	0.00082	ASTM E2178 (cfm/ft <sup>2</sup> @1.57 psf)
	>2500	Gurley Hill (TAPPI-T460) (sec/100cm)
Water Vapor Transmission	385	ASTM E96 Method A (g/m <sup>2</sup> /24 hrs)
	55	(perms)
	465	ASTM E96 Method B (g/m <sup>2</sup> /24 hrs)
	67	(perms)
Water Penetration Resistance	>300	AATCC 127 (cm)
Basis Weight	2.2	TAPPI T-410 (oz/sq yd)
Thickness	8	ASTM D3776 (mils)
Breaking Strength	30	ASTM D882 (lb/in) MD
	30	ASTM D882 (lb/in) CD
Dry Tensile	45	ASTM D5034 (lb/in) MD
	45	ASTM D5034 (lb/in) CD
Tear Resistance (Trapezoid)	13.5	ASTM D1117 (lbs) MD
	12.5	ASTM D1117 (lbs) CD
Drainage Efficiency	>95%	ASTM E2273
	>95%	ICC-ES AC 235 Section 4.5
Surface Burning Characteristics	5 Class A	ASTM E84 Flame Spread Index
	45 Class A	Smoke Develop Index
Ultra Violet Light Exposure	180 days	

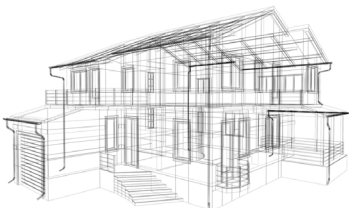

# X WRAP Commercial

## PRODUCT SPECIFICATIONS

**X Wrap Commercial** is the only choice for demanding applications to protect from severe weather conditions and environments in multi-family dwellings or commercial buildings that exceed 4 stories. **X Wrap Commercial** prevents the infiltration of air and water while still allowing for the escape of water vapor. The most unique feature is the *ALTA 360 degree* drainage that no other wrap in the world can give. **X Wrap Commercial** can drain in EVERY direction, and gives you the peace of mind to aid in controlling energy cost of the structure. With the use of *ALTA 360 degree X Wrap Commercial* is a one of a kind all weather protection layer for commercial construction with the assurance of quality and lifelong service.

- Custom print available in two colors, with one pallet minimum, at no additional cost
- Nationwide distribution

Roll Size	Rolls Per Pallet
36" x 100'	50 Rolls
36" x 150'	45 Rolls
54" x 100'	100 Rolls
54" x 150'	90 Rolls
9' x 100'	50 Rolls
9' x 150'	45 Rolls
9' x 195'	40 Rolls
10' x 100'	50 Rolls
10' x 150'	45 Rolls
10' x 195'	40 Rolls

Product Specifications		Test Method
Air Penetration Resistance	0.0008	ASTM E2178 (cfm/ft2@1.57 psf)
	>1800	Gurley Hill (TAPPI-T460) (sec/100cm)
	Type 1	ASTM E1677
Water Vapor Transmission	245	ASTM E96 Method A (g/m2/24 hrs)
	35	(perms)
	435	ASTM E96 Method B (g/m2/24 hrs)
	62.6	(perms)
Water Penetration Resistance	>300	AATCC 127 (cm)
Basis Weight	2.3	TAPPI T-410 (oz/sq yd)
Thickness	8	ASTM D3776 (mils)
Breaking Strength	30	ASTM D882 (lb/in) MD
	30	ASTM D882 (lb/in) CD
Dry Tensile	45	ASTM D5034 (lb/in) MD
	45	ASTM D5034 (lb/in) CD
Tear Resistance (Trapezoid)	13.5	ASTM D1117 (lbs) MD
	12.5	ASTM D1117 (lbs) CD
Drainage Efficiency	>95%	ASTM E2273
	>95%	ICC-ES AC 235 Section 4.5
Surface Burning Characteristics	15 Class A	ASTM E84 Flame Spread Index
	45 Class A	Smoke Develop Index
Ultra Violet Light Exposure	180 days	



## Norandex Seam Tape

**Norandex Seam Tape** is a high strength PET film designed for the toughest conditions with great cold and warm weather applications.

- Formulated with a “quick-tack” adhesive to speed installation
- 3” wide versus standard 2” wide tapes – more surface area to cover seams
- Easy quick tear edges to speed installation
- Excellent initial and long term adhesion
- Excellent chemical and thermal stability



Product Specifications	
3”x165’	Per Roll
16 Rolls	Per Box
12 Boxes	Per Layer
12 Layers	Per Pallet
2,304 Rolls	Rolls per Pallet

### SHELF LIFE

Recommend one year from date of receipt by customer when stored under optimum conditions. (70°F, 50% RH) Note: To the best of our knowledge, these are typical property values and are intended as guides only, not as specification limits. NORANDEX BUILDING PRODUCTS MAKES NO WARRANTIES AS TO THE FITNESS FOR A SPECIFIC USE OR MERCHANTABILITY OF PRODUCTS REFERRED TO, no guarantee of satisfactory results from reliance upon contained information or recommendations and disclaims all liability for resulting loss or damage.

Property Tested	Results
Backing	Polyester (PET)
Adhesive Material	High Tack Acrylic
Thickness	3.38 mil.
Adhesion (Peel)	60.0 oz./in.
Tensile Strength	20 lbs./in. width
Color	White
Roll Width	3 in.
Roll Length	165 Lineal Feet
Service Temperature	-22°F to 148°F
Application Temperature	-4°F to 105°F

## Norandex Window & Door Flashing

**Norandex Window & Door Flashing** is a premium self-adhering butyl flashing that fulfills all requirements for AAMA 711 level 3, features a wide performance and application temperature range and is suitable for applications below freezing. It shows excellent adhesion to OSB, brick, stucco and metal, as well as all common types of house-wrap. It can be used in connection with most sealants and will self-seal around nails. It is designed to stay flexible and will provide a tight water seal even in extreme weather situations.



Property Tested	Product Specifications	Test Method
Color	White	
Thickness	15 mils	
Water Penetration Resistance	Pass (Initial)	AAMA 711-13
(Around Nails)	Pass (After Thermal Cycling)	ASTM D1970
90° Peel Adhesion		
Over OSB	Pass	AAMA 711-13
Over Aluminum	Pass	AAMA 711-13
Over Vinyl	Pass	AAMA 711-13
Over Plywood	Pass	AAMA 711-13
Tensile Strength	115	ASTM D5034 (lb/in) MD
	95	ASTM D5034 (lb/in) CD
Min Application Temp	18° F	AAMA 711-13
Elongation	620% (At Break)	ASTM D5035
Tear Strength	38	ASTM D5587 (lbs)
Adhesion after Water Immersion	Pass	AAMA 711-13
Chemical Compatibility	Pass	AAMA 713
Resistance to Peeling	Pass Level 3 @ 176° F	ASTM D3330
Peel/Heat Distortion	Pass Level 3	AAMA 711
Low Temperature Flexibility	Pass - no signs of cracking	ASTM D1970
Ultra Violet Light Exposure	120 days	

Product Specifications	
4"x75'	9 Rolls/Box
6"x75'	6 Rolls/Box
9"x75'	4 Rolls/Box
12"x75'	3 Rolls/Box

42 boxes per pallet

*Shelf Life: Recommend one year from date of receipt by customer when stored under optimum conditions. (70°F, 50% RH) Note: To the best of our knowledge, these are typical property values and are intended as guides only, not as specification limits. NORANDEX BUILDING PRODUCTS MAKES NO WARRANTIES AS TO THE FITNESS FOR A SPECIFIC USE OR MERCHANTABILITY OF PRODUCTS REFERRED TO, no guarantee of satisfactory results from reliance upon contained information or recommendations and disclaims all liability for resulting loss or damage.*